

Balanced Pressure Proportioner - Mk2

PP

(replaces datasheets 1010/19 and 23)

General description

The balanced PP proportioner induces foam concentrate into the water feed line. Foam proportioning accuracy is maintained during fluctuations in water flow and pressure.

Application description - PP

This type of proportioner is used in foam pump systems. The PP series is designed for monitor and deluge systems.

Product features

- Maintenance free design
- High quality, high reliability
- Manufactured using corrosion resistant design and materials
- Factory set to deliver accurate foam proportioning over full performance range, up to 3%
- Wafer type water connection
- Flanged or screw threaded BSP foam connection

Connections

- Water: wafer mounted between flanges, see table
- Foam: flanged to fit DIN or ANSI or threaded BSP, see table

Listings and approvals

- Det Norske Veritas (DNV)
- Tested according to and complying with EN 13565-1



PP-80

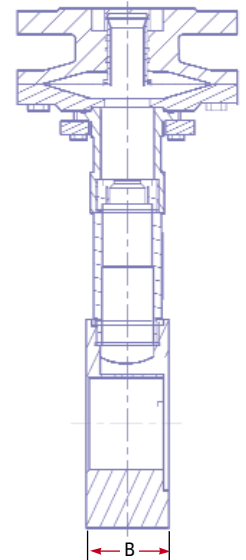
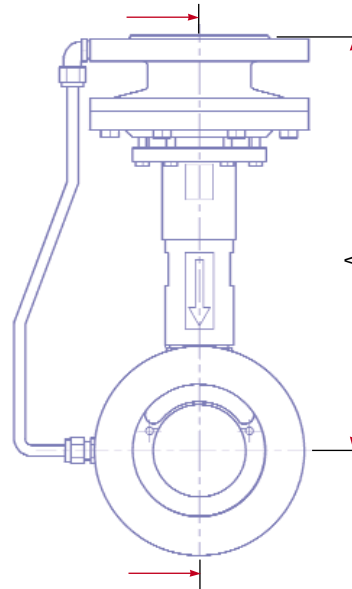

Performance Data PP Proportioners

Type	Connection		Capacity				Proportioner k-factor	Weight		Max. working Pressure		Material
			Min.		Max.*							
	Foam	Water	l/min	USGPM	l/min	USGPM		kg	lbs	bar	psi	
PP-50	3/4" BSP	50 / 2"	125	33	800	211	300	6	13	16	235	Bronze (Cu88Sn12)
PP-80	3/4" BSP	80 / 3"	300	79	2,000	528	1,010	10	22	16	235	Bronze (Cu88Sn12)
PP-100	50 / 2"	100 / 4"	770	203	6,100	1,612	4,040	18	40	16	235	Bronze (Cu88Sn12)
PP-150	50 / 2"	150 / 6"	1,500	396	18,000	4,756	7,990	21	46	16	235	Bronze (Cu88Sn12)
PP-200	80 / 3"	200 / 8"	2,875	760	36,500	9,643	17,255	43	95	16	235	Bronze (Cu88Sn12)
PP-250	80 / 3"	250 / 10"	5,100	1,347	37,850	10,000	27,060	53	117	16	235	Bronze (Cu88Sn12)

*At proportioner system pressure drop 1.5 bar Q l/min. = \sqrt{P} bar = k-factor
1 bar = 0,1 MPa = 14,5 psi

Dimensions PP

Type	A mm	B mm
PP-50/20	200	37
PP-80/20	200	37
PP-100	312	62
PP-150	333	62
PP-200	411	82
PP-250	439	82



www.skum.com

tyco Fire Suppression & Building Products

Balanced Pressure Proportioner - Mk2

PP

(replaces datasheets 1010/19, 23 and 40)

Operation

The proportioner will operate automatically when the flows and pressure are within the flow range. The foam pressure must be at least one bar higher than the water pressure through the proportioner. Operates all valves in the system smoothly.

Fitting

A minimum of five diameters (D) of straight pipe is required in the water line before entering the proportioner and three diameters (D) after the proportioner.

Order information - please specify:

1. Size
2. Connection: DIN or ANSI
3. Foam concentrate mixing rate (%)



PP-150

